

ES, ESO SERIES VALVES MANIFOLDS



26081-□

Single-Sided
Dual Mount

Suffix	Valves	L	M1	M2
-4	4	4.375"	2.875"	4.000"
-4-M5	4	111.1 mm	73.0 mm	101.6 mm
-6	6	6.125"	4.625"	5.750"
-6-M5	6	155.6 mm	117.5 mm	146.1 mm
-8	8	7.875"	6.375"	7.500"
-8-M5	8	200.0 mm	161.9 mm	190.5 mm

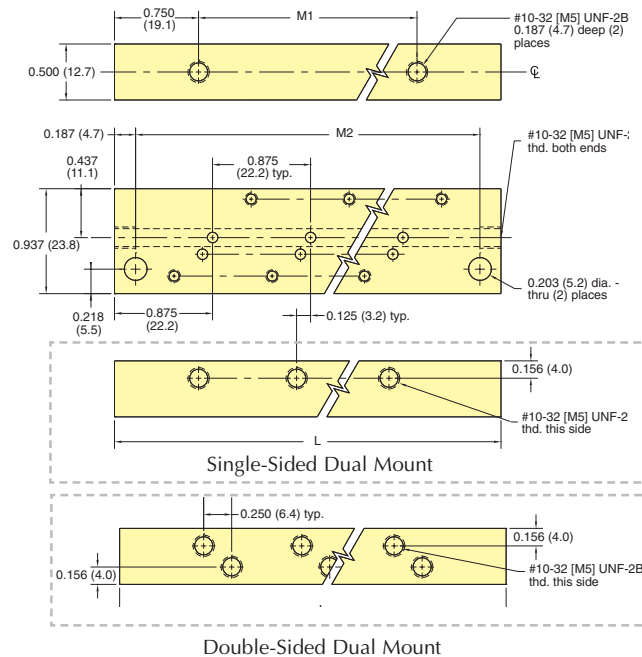

26082-□

Double-Sided
Dual Mount

Suffix	Valves	L	M1	M2
-8	8	4.375"	2.875"	4.000"
-8-M5	8	111.1 mm	73.0 mm	101.6 mm
-12	12	6.125"	4.625"	5.750"
-12-M5	12	155.6 mm	117.5 mm	146.1 mm
-16	16	7.875"	6.375"	7.500"
-16-M5	16	200.0 mm	161.9 mm	190.5 mm

* ESM-CP plate is to cover individual unused manifold station.

26083-□

Single-Sided
Rear Mount

Suffix	Valves	L	M
-4	4	3.500"	2.875"
		88.9 mm	73.0 mm
-6	6	5.250"	4.625"
		133.4 mm	117.5 mm
-8	8	7.000"	6.375"
		177.8 mm	161.9 mm

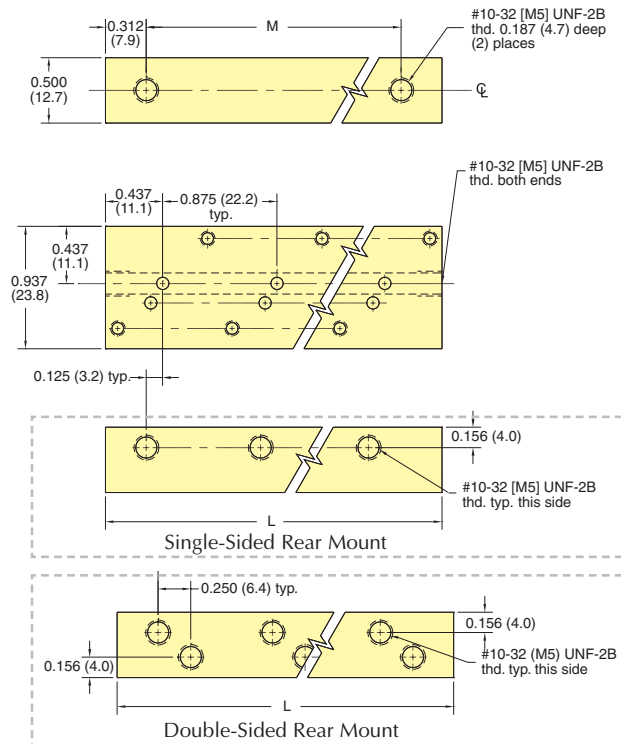

26084-□

Double-Sided
Rear Mount

Suffix	Valves	L	M
-8	8	3.500"	2.875"
-8-M5	8	88.9 mm	73.0 mm
-12	12	5.250"	4.625"
-12-M5	12	133.4 mm	117.5 mm
-16	16	7.000"	6.375"
-16-M5	16	177.8 mm	161.9 mm

* ESM-CP cover plate is available for one manifold station.



ES, ESO SERIES VALVES SINGLE MANIFOLDS

26090-1



Single Station Side Port Manifold

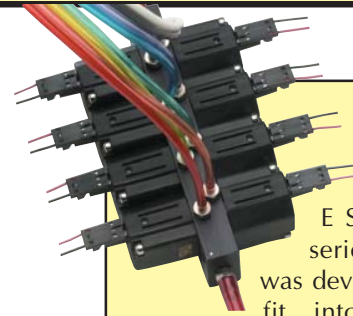
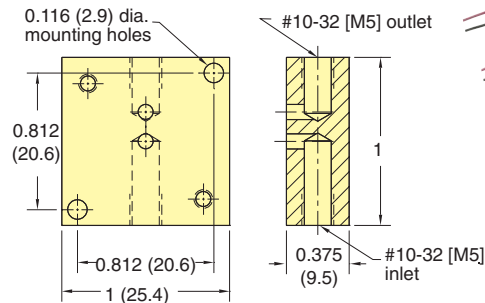

The ES/ESO series valve was developed to fit into tighter physical envelopes. By reducing the size of the base as well as the size of the coil, a considerable volume savings was achieved.

26090-2



Single Station Bottom Port Manifold

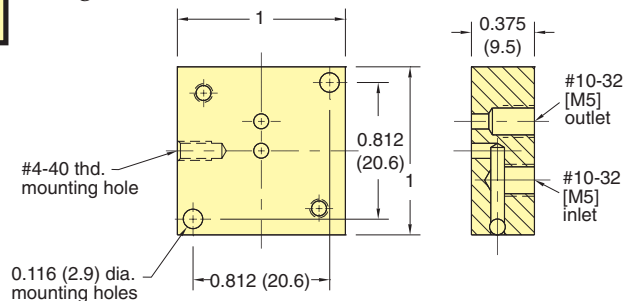

As in the case of the EV/EVO product, the ES/ESO uses the single moving part design proven many times in the EV/ET/EC series valves. Of course, given the reduced size of the coil the power to operate increases to 1 watt.

26090-3



Dual Station Manifold

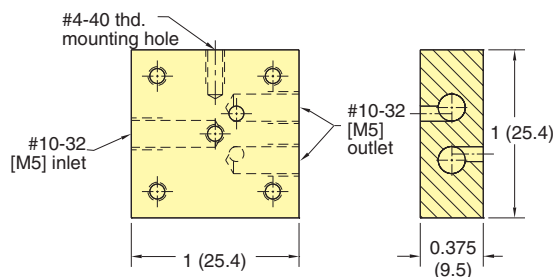

Because of its reliability, the ES/ESO series valve is found in many of the same applications and industries as its predecessor, the EV/ET/EC. However, the smaller size finds it used more commonly in portable or mobile equipment. This makes the valve particularly applicable in home healthcare applications.

C3-RXB18



AMP Connector #103960-2 with 18" wire leads for ES/ESO valves

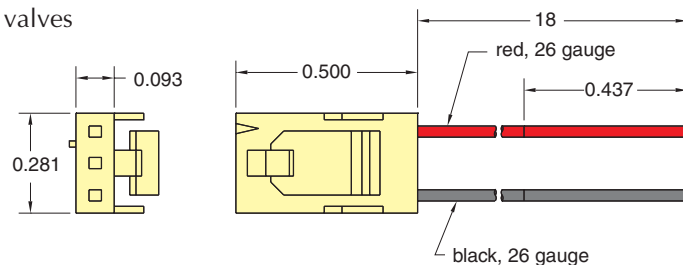

Lead Set Chart For ES Valve

Part No.	Used On	Wire Colors			Lead Length	Wire Gage
		Pin 1	Pin 2	Pin 3		
C3-RXB18	ES	red	~	black	18"	#26