

PUSH-QUICK FITTINGS WITH MJQC QUICK-CONNECT PORT

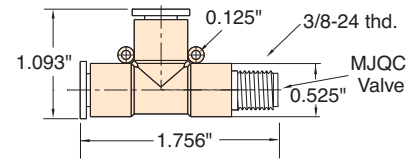

These 1/4" fittings combine the quick, easy Push-Quick functionality with the flexibility and security of the Quick-Connect series with no circuit interruption. MJQC Quick-Connect Caps (ordered separately above) attach to the threaded port allowing for a variety of uses.

Part No.	Description
PQ-RT08QC	...Run T with 3/8-24 Thread
PQ-BT08QC	...Branch T with 3/8-24 Thread



PQ-RT08QC

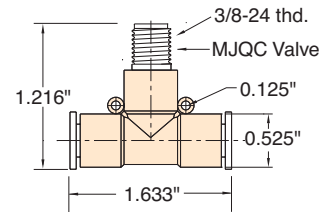

PQ-BT08QC

- Serves as an easy connection point for temporary functions/circuitry
- Quickly test for air flow
- Easy connection to valves, cylinders, hose, etc.
- Check air pressure via a gauge
- Use as a dump valve/vent

MQC-2S

Quick Connect Assembly

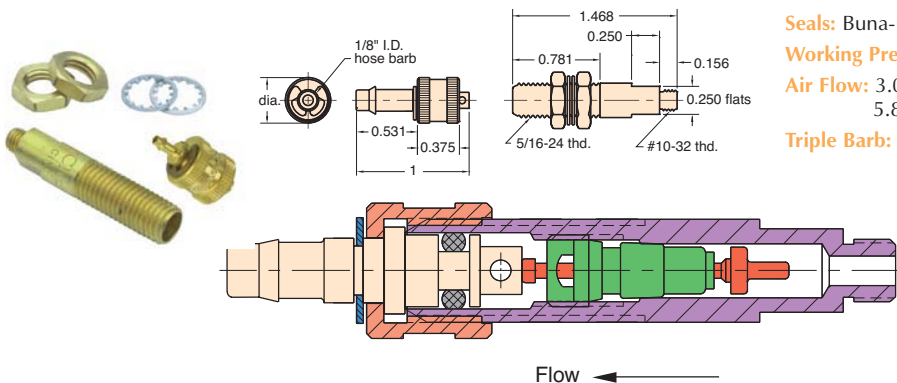

Type: One way check quick connect assembly of valve body MQC-V2 and hose connector MQC-F

Material: Body- brass, Stem- brass

Seals: Buna-N

Working Pressure: 0 to 300 psig

Air Flow: 3.0 scfm @ 50 psig
5.8 scfm @ 100 psig

Triple Barb: Order MQC-2

MQC-3S

Quick Connect Assembly

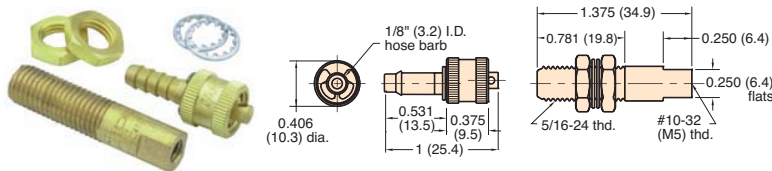

Type: One way check quick connect assembly of valve body MQC-V3 and hose connector MQC-F

Material: Body- brass, Stem- brass

Seals: Buna-N

Working Pressure: 0 to 300 psig

Air Flow: 3.0 scfm @ 50 psig
5.8 scfm @ 100 psig

Triple Barb: Order MQC-3 or MQC-3-M5 (metric)

MQC-V2

Valve Body

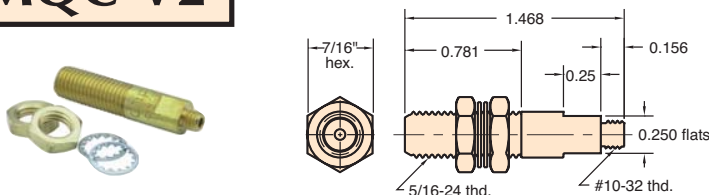

Material: Brass

Thread: #10-32 male

Mounting: In panel or bracket to 1/4" thick with two 7/16" mounting nuts and lockwashers furnished; also screws directly into operative unit or manifold

Seals: Buna-N

Use: For connection with external shut-off to external hose, use hose connectors: MQC-F, MQC-FT, MQC-F2

Options: (-ENP)





MINIMATIC® QUICK CONNECT

MQC-V3



Valve Body

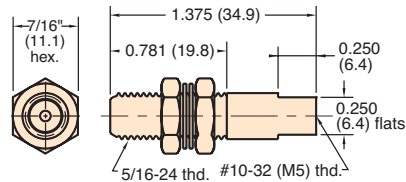

Material: Brass

Thread: Tapped #10-32

Mounting: In panel or bracket to 1/4" thick with two 7/16" mounting nuts and lockwashers furnished; like MQC-V2, but end is tapped #10-32 instead of threaded

Seals: Buna-N

Use: For connection with external shut-off to external hose, use hose connectors: MQC-F, MQC-FT, MQC-F2

Options: (-ENP), (-M5)



MQC-VP



Valve Body

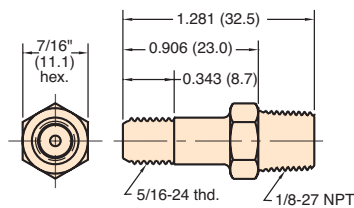

Material: Brass

Thread: 1/8" NPT base; 5/16-24 body

Use: For connection with external shut-off to external hose, use hose connectors: MQC-F, MQC-FT, MQC-F2

Seals: Buna-N

Options: (-ENP), (-MR)

MQC-FS



1/8" Hose Connector

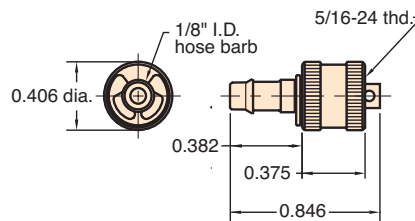

Material: Brass

Thread: I.D. of knurled end screws onto male end of valve bodies

For Use With: 1/8" I.D. Vinyl, Buna-N or braided hose

Installation: Simply push hose onto barbed end and secure with hose clamp 5000-1, 5000-2 or 5000-1A.

Seals: Buna-N

Options: (-ENP)

Triple Barb: Order MQC-F

MQC-F2S



1/16" Hose Connector

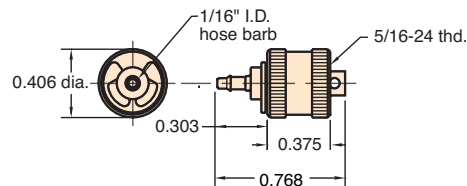

Material: Brass

Thread: I.D. of knurled end screws onto male end of valve bodies

For Use With: Subminiature VYH1-0402-CLT 1/16" ID vinyl hose

Installation: Simply push hose onto barbed end and secure with slip-over hose clamp furnished

Seals: Buna-N

Options: (-ENP)

Triple Barb: Order MQC-F2



MQC-FT



#10-32 (M5) Tapped Connector

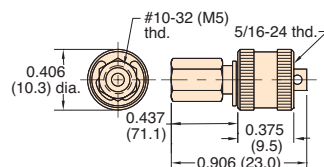

Material: Brass

Thread: Outlet is tapped #10-32 or M5 Metric. I.D. of knurled end screws onto male end of valve bodies: MQC-V2, MQC-V3, MQC-VP

Mounting: Outlet mounts with #10-32 (M5) short coupling 11999

Seals: Buna-N

Options: (-ENP), (-M5)



Tip

When assembling #10-32 threaded fittings with gaskets, turn the fitting in until the gasket contacts the surface. Then give the fitting less than a 1/4 turn to achieve a good seal.