

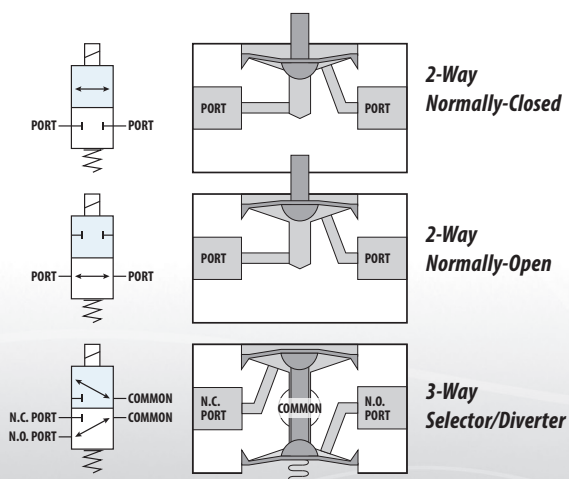

## NIV Series Media Isolation Valves



- Low power consumption
- Compact, lightweight design
- Bidirectional
- Minimal dead volume
- All wetted areas PTFE
- Ideal for use with corrosive media
- High cycle life
- Fast response time
- CE, RoHS Compliant
- Proudly made in the U.S.A.
- ISO 9001:2008



The **Clippard NIV Series Media Isolation Valve** is a solenoid-operated device that uses a flexible diaphragm to isolate the actuation mechanism from the fluid path. Media isolation valves are commonly used for a wide variety of applications, including those that require precise, repeatable dispensing of media for analytical instrumentation. All wetted areas of the valve are PTFE, making this series ideal for use with corrosive media.

A unique feature of the NIV Series is the one-piece valve stem that functions as a sealing membrane while also supporting and centralizing the poppet in the seating area. This multifunctional poppet/diaphragm/stem results in a simplified design with fewer parts (only two for the 2-way and three for the 3-way), longer life and minimal dead volume. Choose from four orifice sizes available as 2-Way Normally-Closed, 2-Way Normally-Open, or 3-Way Selector/Diverter. Special configurations available by request.

Industries and applications that commonly use these types of valves to isolate gas or liquid include: drug dispensing, laboratory equipment, analytical, chemical analysis, sampling, life science/biotech, genetic research, gas chromatography, spectrometry, DNA synthesizing, blood analyzing, printing, diagnostic equipment, fermentation, water treatment and more.

### SPECIFICATIONS

<b>Valve Type</b>	2-Way Normally-Closed, 2-Way Normally-Open, 3-Way Selector/Diverter
<b>Medium</b>	Air, water, gas, compatible fluids
<b>Max. Temperature Range</b>	70°C
<b>Operating Pressure</b>	Vacuum to 30 psi
<b>Flow</b>	10 to 60 L/min
<b>Max. Pressure Range</b>	28" Hg to 30 psi
<b>Power Consumption</b>	1.0 to 7.2 watts
<b>Response Time</b>	5 to 20 ms
<b>Electrical Connections</b>	18" wire leads
<b>Voltage</b>	12 or 24 VDC
<b>Ports</b>	#10-32, 1/4-28 or 1/8 NSPC
<b>Mounting</b>	#2-56, #4-40
<b>Wetted Materials</b>	PTFE
<b>CE, RoHS Compliant</b>	

**CLIPPARD INSTRUMENT LABORATORY, INC.**

7390 Colerain Avenue, Cincinnati, Ohio 45239 • (513) 521-4261 • (877) 245-6247 • ISO 9001:2008



## Dimensions

Valve Type	Orifice Size	Ports	Part Number	Dimensions								Fig.
				A	B	C	D	E	F	G	H	
2-Way N.C.	0.040	#10-32	NR1-2	0.750	1.155	0.500	#2-56 x 0.094 deep	0.363	0.500	n/a	#2-56 x 0.188 deep	1
	0.062	1/4-28	NR2-2	1.000	1.488	0.486	#4-40 x 0.125 deep	0.450	0.687	n/a	#4-40 x 0.250 deep	2
	0.093	1/4-28	NR3-2	1.250	1.863	0.626		0.500	0.884	1.500		4
	0.156	1/8 NPSC	NR4-2	1.500	2.088	0.796		0.562	1.125	1.750		4
2-Way N.O.	0.040	#10-32	NR10-2	0.750	1.163	0.500	#2-56 x 0.094 deep	0.363	0.500	n/a	#2-56 x 0.188 deep	1
	0.062	1/4-28	NR20-2	1.000	1.493	0.486	#4-40 x 0.125 deep	0.450	0.687	n/a	#4-40 x 0.250 deep	3
	0.093	1/4-28	NR30-2	1.250	1.814	0.884		0.500	0.884	1.500		5
	0.156	1/8 NPSC	NR40-2	1.500	2.039	1.125		0.562	1.125	1.750		5
3-Way	0.040	#10-32	NR1-3	0.750	1.161	0.500	#2-56 x 0.094 deep	0.363	0.500	n/a	#2-56 x 0.188 deep	1
	0.062	1/4-28	NR2-3	1.000	1.492	0.687	#4-40 x 0.125 deep	0.450	0.687	n/a	#4-40 x 0.250 deep	3
	0.093	1/4-28	NR3-3	1.250	1.814	0.884		0.500	0.884	1.500		5
	0.156	1/8 NPSC	NR4-3	1.500	2.038	1.125		0.562	1.125	1.750		5

## Coil Chart

Model	Power	Voltage	Amps
NR1	1.0 W	12 VDC	0.08
		24 VDC	0.04
NR2	1.5 W	12 VDC	0.13
		24 VDC	0.06
NR3	4.2 W	12 VDC	0.40
		24 VDC	0.18
NR4	7.2 W	12 VDC	0.60
		24 VDC	0.30

Unless otherwise noted, all measurements shown are in inches.

FIGURE 1

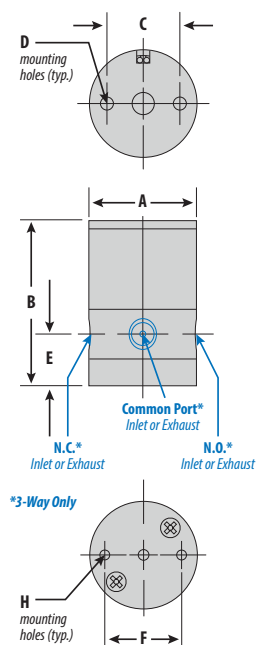

FIGURE 2

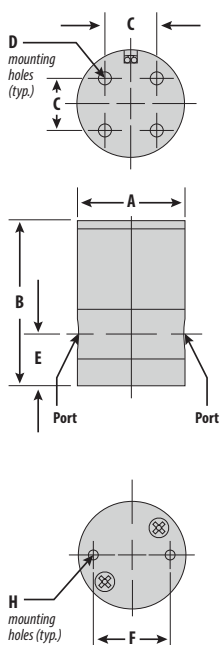

FIGURE 3

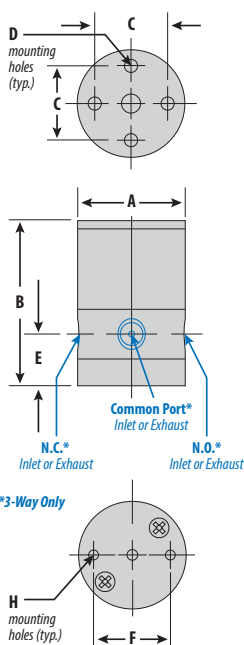

FIGURE 4

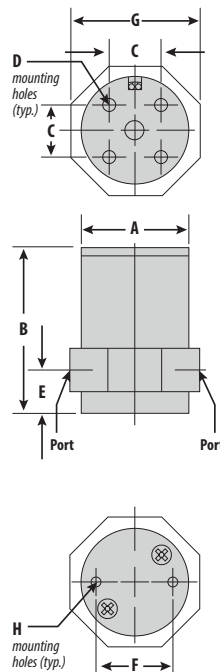
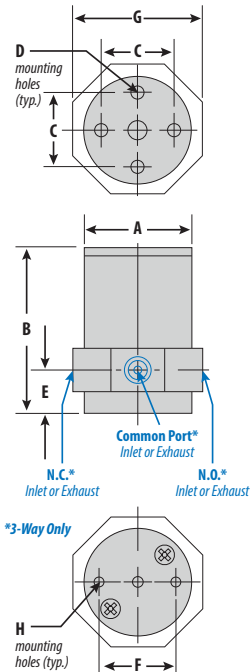

FIGURE 5



Professionally Distributed by:

CLIPPARD INSTRUMENT LABORATORY, INC.

7390 Colerain Avenue, Cincinnati, Ohio 45239 • (513) 521-4261 • (877) 245-6247 • ISO 9001:2008

